

PRO-SYS®

PROFESSIONAL

JetFloss®

Quick Start Guide & User Manual



PRO-SYS® JetFloss™ Water Flosser
Quick Start Guide & User Manual

Welcome	4
What's In The Box.....	5
Product Features.....	6
Quick Start Guide	7
Preparing For Use	8
Choosing The Right Tip.....	9
Using The 360° Wand	10
Operating The Unit.....	11
Cleaning And Storage	12 - 13
Troubleshooting	14 - 15
Safety Instructions	16 - 17
Warranty.....	19

THANK YOU

JetFloss by PRO-SYS is designed to elevate your personal care routine to the next level of clean. It gently and safely removes plaque and debris from even the hardest-to-reach spaces. It's also an effective solution for cleaning around braces, veneers or other appliances.

Please read all included instructions thoroughly prior to using JetFloss to ensure you get the most from every session.

We sincerely appreciate your purchase.

What's In The Box

- 1 JetFloss Water Flosser
- 2 Twelve Oral Tips
- 3 Quick Start Guide & User Manual
- 4 Personalizing Your JetFloss Guide

Product Features

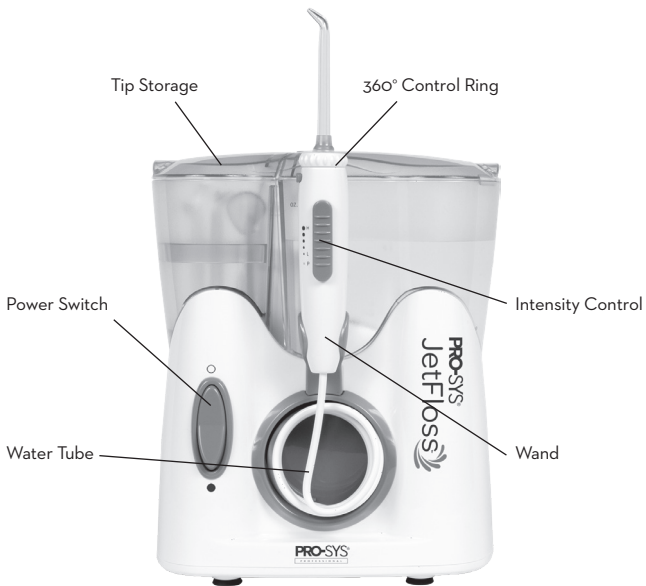

Quick Start Guide

To get the most from your JetFloss, please take a moment to thoroughly read the entire Quick Start Guide & User Manual and Personalizing Your JetFloss Guide booklets.

1. Remove the unit and accessories from all packaging.
2. If desired, prior to initial use, remove the water reservoir, tip storage, and tips from the base. Wash the water reservoir thoroughly with mild soap and warm water. Allow to dry thoroughly. Reassemble.
3. Connect the power cord to AC outlet.
4. Fill the reservoir with water.
5. Insert desired tip into wand.
6. Direct jet tip into sink. Turn power on.
7. Place the tip into mouth and clean desired areas. Use the intensity control to adjust water jet pressure as needed.
8. Turn power off. Empty any remaining water in reservoir. Disconnect power cord from AC outlet.
9. Regularly clean reservoir and used tips by washing with mild soap and warm water and allowing them to dry completely.

IMPORTANT: Never expose base to excess moisture or submerge in water. See complete safety information on pages 16 and 17.

Preparing For Use

Remove the unit and accessories from all packaging. If desired, prior to initial use, remove the water reservoir, tip storage, and tips from the base. Wash thoroughly with mild soap and warm water. Allow to dry thoroughly before reassembling.

CONNECT TO POWER SOURCE

Position the base on a level, non-slippery surface in a convenient location near the desired AC outlet. Be careful to situate unit so it is not exposed to excess moisture or in danger of falling or sliding into water as the base should never be submerged in water.

Choosing The Right Tip

Four types of tips are included in various quantities. To order replacement tips, visit PRO-SYS.com or call 1-866-776-7971.



JET

General purpose. Reaches around teeth and under the gumline.



ORTHODONTIC

Designed for safe cleaning around braces, veneers, partials, implants and other orthodontic appliances.



PERIODONTAL

Massages gums while reaching gently into pockets.



TONGUE

Helps freshen breath and remove bacteria.

Using The 360° Wand

ATTACHING AND REMOVING TIPS

Hold the wand firmly in one hand. Using your other hand, insert tip into wand with gentle pressure until you feel a slight click and there is no visual gap between the wand and the 360° control ring. To remove tip, press the tip eject button and pull tip up and away from the wand.

ADJUSTING WATER JET PRESSURE

Slide the wand's water intensity control up to increase pressure and down to decrease. Choose what is most comfortable or what your dentist recommends for your oral condition.

DIRECTING THE WATER JET

Use the 360° control ring, located at the top of the wand where the tip attaches, to change the direction of the water jet without rotating the entire wand.

Operating The Unit

FILLING THE RESERVOIR

Open the reservoir cover and detach entire reservoir by lifting it up and off the base. Fill with water of desired temperature. (NEVER use hot or boiling water as it may cause injury and also damage the unit.) Return the reservoir to the unit and press down firmly until attached.

FLOSSING WITH WATER USING JETFLOSS

Slide the water intensity control on the wand to its lowest setting. Direct the tip into sink. Turn the unit's power on. Lean over the sink. Place the tip into your mouth and close your lips enough to prevent water from spraying or splashing. Let water from the tip flow from your mouth and into the sink. Aim the tip between teeth and at the gumline, cleaning the areas you would normally floss. For detailed recommendations, refer to the included Personalizing Your JetFloss Guide booklet.

AFTER USE

Empty reservoir of any remaining water and replace onto base. Direct the tip into the sink and press the power button to turn the unit on. Operate the unit for a few seconds to flush out any remaining water in the wand or water tube. Turn power off when water no longer flows. Remove the tip by pressing the tip eject button. Unplug power cord. Follow cleaning and storage instructions on pages 12 and 13.

Cleaning And Storage

IMPORTANT: NEVER EXPOSE BASE TO EXCESS MOISTURE OR SUBMERGE IN WATER. If it becomes accidentally submerged, safely disconnect from power source immediately. DO NOT attempt to operate after being fully submerged as damage may have occurred. Always disconnect from power before cleaning and when not in use.

AFTER EVERY USE

- Empty reservoir of remaining water and replace onto base. Direct the tip into the sink and press the power button to turn the unit on. Operate the unit for a few seconds to flush out any remaining water in the wand or water tube. Turn power off when water no longer flows.
- Allow the reservoir to dry completely between uses to avoid bacteria from forming. If desired, you may thoroughly wash it with mild soap and warm water and allow to dry completely.
- Thoroughly rinse/flush used tips with water and allow to dry completely. If desired, wash with mild soap and warm water and allow them to dry completely.
- Disconnect from power when not in use.

Cleaning And Storage

AFTER REPEATED USAGE

- Regularly inspect the entire unit for soil. Wipe the unit clean as needed using a soft cloth dampened with mild, non-abrasive cleaner.
- To prevent bacteria growth, it is recommended to thoroughly wash/flush used tips and water reservoir with mild soap and warm water and allow to dry completely.
- Occasionally fill the reservoir with a solution of soapy water and operate unit to flush the water tube and internal pieces. Then rinse the reservoir until no soap remains, fill with clean water and operate the unit again to flush out any remaining soapy water until completely empty.
- Clean the tip storage area as needed.

FOR BEST PROTECTION

- Store your JetFloss in a clean, dry place.
- Avoid storing in extreme temperature conditions.
- Keep away from children.

Troubleshooting

PROBLEM:

Unit will not operate.

POSSIBLE CAUSE:

Unit is not connected to power.

SOLUTION:

Connect the plug to AC power outlet.

PROBLEM:

Water leaks between wand and tip.

POSSIBLE CAUSE:

Tip is not fully inserted.

SOLUTION:

Remove tip, then reinsert until you feel a slight click.

PROBLEM:

Visible leaks, tears, or cracking on tips.

POSSIBLE CAUSE:

Tip is damaged.

SOLUTION:

Replace with new tip by visiting PRO-SYS.com.

PROBLEM:

Water leaks from tube.

POSSIBLE CAUSE:

Tube is damaged.

SOLUTION:

Contact customer service at 1-866-776-7971 or email info@PRO-SYS.com

PROBLEM:

Water leaks from bottom of reservoir.

POSSIBLE CAUSE:

Reservoir is not properly seated or connector is missing/damaged.

SOLUTION:

Remove and replace reservoir using firm downward pressure. If water still leaks, check that the connector from bottom of reservoir to top of unit is in place and undamaged.

PROBLEM:

Water pressure from tip is low.

POSSIBLE CAUSE:

Reservoir is not properly seated.

SOLUTION:

Remove and replace reservoir using firm downward pressure.

Safety Instructions

NEVER

- Leave children unattended or allow their unsupervised use.
- Expose the unit to excess moisture or extreme temperatures.
- Submerge base in water.
- Attempt to open the unit, repair or replace any internal parts. The unit is not user serviceable.
- Use an extension cord to connect to power source.
- Kink the power cord or lay it near sharp objects.
- Drop any part of the unit. Do not attempt to use if any part has been subjected to a fall or drop as it may have been damaged and is subject to malfunction.
- Operate the unit if it appears visibly damaged, cracked or warped in any way, or if you suspect damage or malfunction.
- Leave the unit unattended while the power is on.
- Operate unit while showering or bathing.
- Fill reservoir or operate unit using boiling or hot water.
- Use this product as not intended.
- Use parts or attachments not recommended by the manufacturer.

Safety Instructions

ALWAYS

- Inspect regularly for damage and discontinue use immediately if any is found.
- Keep the unit and all accessories in a cool, dry place and away from children.
- Use in a room temperature environment.
- Consult your healthcare providers with any questions about your oral health and the use of this product.
- Unplug the unit after every use.

CAUTION

- The appliance is not to be used by persons (including children) with reduced physical, sensory or mental capabilities, or lack of experience and knowledge, unless properly supervised and instructed.

IMPORTANT: YOUR JETFLOSS HAS A 1-YEAR WARRANTY.

If malfunction cannot be remedied by following the instructions on pages 14 and 15, discontinue use immediately and contact customer service. Damage may have occurred and/or certain parts may require replacement.

To register your PRO-SYS JetFloss, please visit www.PRO-SYS.com/warranty or scan this QR code:



Limited Time Offer!

PRO-SYS
PROFESSIONAL

VarioSonic®

Electric Toothbrush

Includes 5 different replacement heads,
travel case, and charger

\$10 OFF

PLUS FREE SHIPPING

100% MONEY BACK GUARANTEED

GO TO
PRO-SYS.COM/VARIOSONIC

Use coupon code:

DMABB9



Limited Time Offer!

PRO-SYS[®]
PROFESSIONAL

JetFloss[™]

Effortless Flossing

Powered By Water

\$10 OFF

PLUS FREE SHIPPING

100% MONEY BACK GUARANTEED

GO TO
PRO-SYS.COM/JETFLOSS

Use coupon code:

DMAAB9



How can we help?

Need to reorder refill tips?

Do you have a question?

Simply visit PRO-SYS.com.

We appreciate your purchase of our PRO-SYS JetFloss Water Flosser.

Please help us and potential buyers by leaving an unbiased review on Amazon.

Please contact us if you have any questions about the product or if there was an issue with your order at info@PRO-SYS.com or call us at 866-PRO-SYS1.

thank you!

ABOUT OUR COMPANY

You may not recognize the PRO-SYS name... but your dentist does.

Founded in 1930, Benco Dental is the leading family-owned distributor of professional dental products and technologies.

PRO-SYS was created in 2014 to make that same professional-grade clinical efficacy available directly to consumers, for a dentist-like clean at home.

Visit PRO-SYS.com to discover our complete line of oral health products.

© 2019 Benco Dental. All rights reserved. PRO-SYS® is a registered trademark of Benco Dental. JetFloss™ is a trademark of Benco Dental.

PRO-SYS®
PROFESSIONAL

JetFloss 

Benco Family
Foundation



BencoDental